

AX heavy duty

STAINLESS STEEL AISI 304 / ACCIAIO INOX AISI 304

ø 410 mm
drum/tamburo

optional [page 88-93](#)

INLET HOSE



AXSG15R



P12A70/80/95



II 2G/D
optional

ordering the "ATEX" version indicating the hose reel code preceded by "EX"
ordinare la versione "ATEX" indicando il codice dell'avvolgitubo preceduto da "EX"



4R - Optional 4-roller hose guide. Ordering the version indicating the hose reel code followed by "4R"
4R - Guida tubo a 4 rulli opzionale. *ordinare la versione indicando il codice dell'avvolgitubo seguito da "4R"*

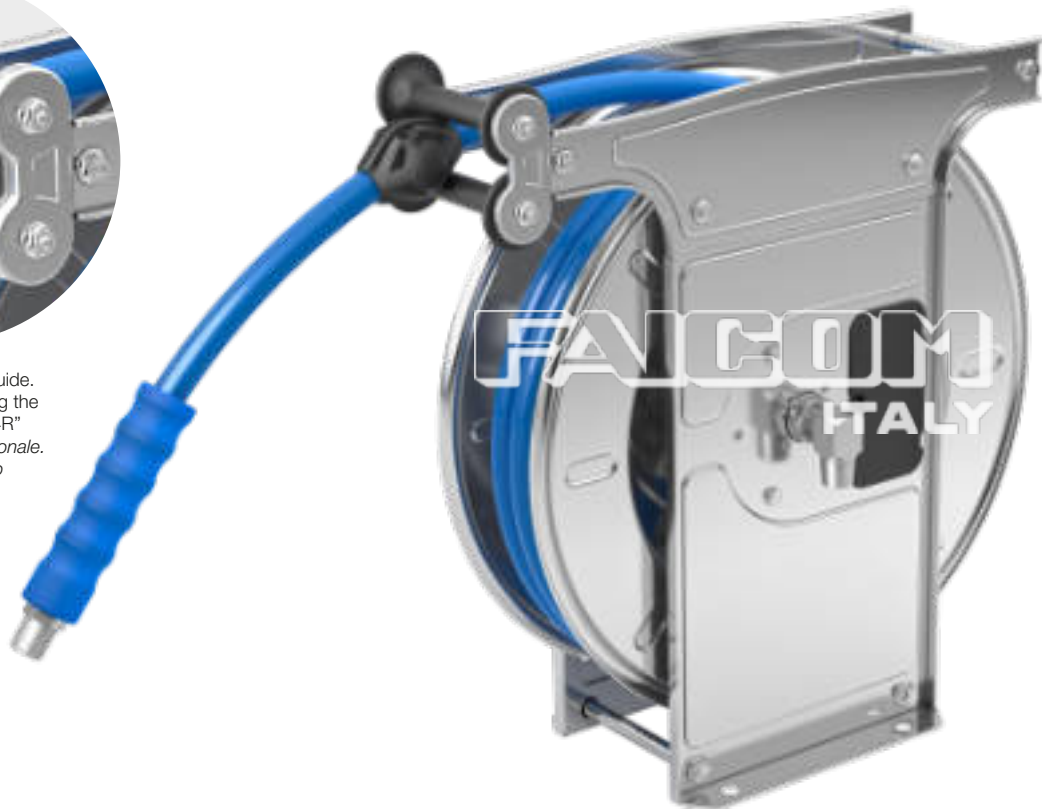

EN Automatic hose reels designed for washing operations with water and detergent at different pressure and temperature conditions. Specific versions with food-quality hose suitable for the passage of water that comes in contact with foodstuffs are also available. The hose-guide support can be mounted in two different positions according to the hose reel installation (pos. A-B). Optional: connection hose, revolving stand, 4-roller hose guide.

FR Enrouleurs automatiques particulièrement adaptés pour opérations de lavage à l'eau et détergents à différentes pressions et températures. Versions avec tuyau de qualité alimentaire indiquées aussi pour le passage d'eau en contact avec les denrées alimentaires. Deux positions possibles du

support guide tuyau pour permettre l'installation désirée (pos. A-B). En option: tuyau de connexion, support pivotant, guide tuyau 4 rouleaux.

DE Schlauchaufroller für Waschvorgänge mit Wasser und Reinigungsmittel für versch. Betriebstemperaturen und -drücke, sowie bei lebensmittelechtem Schlauch auch zum Transport von Wasser für den Kontakt mit Lebensmitteln. Schlauchführungshalterung für 2 verschied. Positionen (s.Abb. A-B). Optional: Schlauchführung mit 4 Rollen, Verbindungsschlauch, Schwenkkonsole.

ES Enrolladores automáticos ideados especialmente para el lavado con agua y detergentes con diferentes presiones y temperaturas. Versiones con mangueras de

calidad alimentaria idóneos también para el paso de agua por contacto con productos alimenticios. Soporte guía manguera aplicable en dos diversas posiciones para permitir la instalación deseada (pos. A-B). Opcional: manguera de conexión, soporte giratorio, guía manguera de 4 rodillos.

IT Avvolgitubo automatici particolarmente adatti per operazioni di lavaggio con acqua e detersivi a diverse pressioni e temperature. Versioni con tubo di qualità alimentare idonee anche per passaggio di acqua per contatto con i prodotti alimentari. Supporto guidatubo applicabile in due diverse posizioni per consentire l'installazione desiderata (pos. A-B). Optional: tubo di collegamento, supporto girevole, guidatubo a 4 rulli.

Dimensions (mm) / Dimensioni (mm)

OPTIONAL ±60°

Pos. A

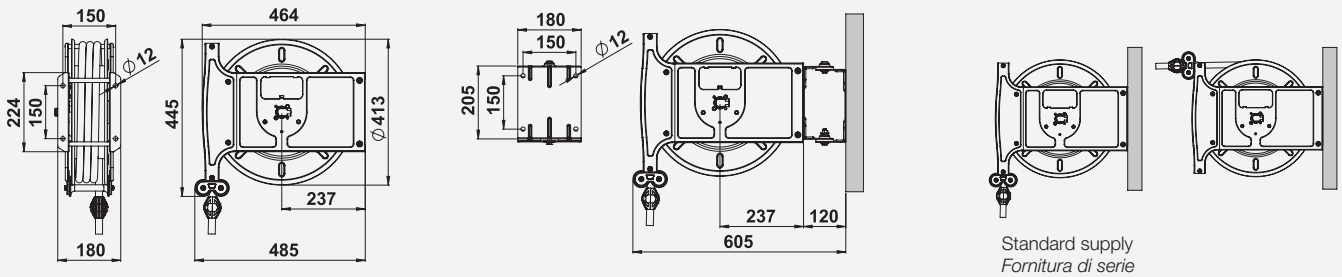

Pos. B



Hose reels model AX without hose / Avvolgitubo modello AX senza tubo

Fluid Fluido	Max. pressure Pressione max.	Code Codice	Inlet (Bsp) Entrata (Gas)	Outlet (Bsp) Uscita (Gas)	Capacity Capacità	Weight (kg) Peso (kg)	ATEX  (optional)
Water/Acqua 100°C	60 bar/870 psi	AX601215ST	1/2" M	1/2" M	(1/2") 15 m/50 ft (5/8") 10 m/32 ft	15,5	•
Water/Acqua 150°C	400 bar/5800 psi	AX4H3815ST	3/8" F	3/8" M	15 m/50 ft	15,5	•

Hose reels model AX with hose / Avvolgitubo modello AX completi di tubo

Fluid Fluido	Pressure - Hose Pressione - Tubo	Code Codice	Inlet (Bsp) Entrata (Gas)	Outlet (Bsp) Uscita (Gas)	Hose diam. Tubo diam.	Hose length Lungh. Tubo	Weight (kg) Peso (kg)	Inlet hose Tubo entrata	ATEX  (optional)
Water Acqua 70°C	10 bar/145 psi (70°C) 20 bar/290 psi (25°C) Blue Thermoplastic 	AX101310K	1/2" M	1/2" M	13 x 20	10 m/32 ft	18	TC13005K	
		AX101315K	1/2" M	1/2" M	13 x 20	15 m/50 ft	20	TC13005K	
		AX101610K	1/2" M	1/2" M	16 x 23	10 m/32 ft	19	TC16005K	
Water Acqua 90°C	10 bar/145 psi (90°C) 20 bar/290 psi (25°C) Blue Rubber/Gomma 	AX101310KR	1/2" M	1/2" M	13 x 21	10 m/32 ft	18	TC1301KR	
		AX101315KR	1/2" M	1/2" M	13 x 21	15 m/50 ft	20	TC1301KR	
Water Acqua 150°C	250 bar/3625 psi 1SC Hydro blue	AX2H3815	3/8" F	3/8" M	3/8"	15 m/50 ft	21	TC38005H	
		AX4H3810	3/8" F	3/8" M	3/8"	10 m/32 ft	20	TC38005H	
	400 bar/5800 psi 2SC Hydro blue	AX4H3815	3/8" F	3/8" M	3/8"	15 m/50 ft	22	TC38005H	•
		AX4H5115	3/8" F	3/8" M	5/16"	15 m/50 ft	21	TC38005H	•
		*AX4H3815X	3/8" F	3/8" F	3/8"	15 m/50 ft	22	T3801HX	

* Hose with stainless steel fittings / Tubo con raccordi in acciaio inox